

**FEATURES**

- Investment Cast Body Construction
- 3 Pieces Body Design
- Spring Type
- Horizontal or Vertical Installation
- Low Pressure Drop
- For General Chemical and Industrial application

**SPECIFICATIONS**

- Size Range DN8 ~ DN100 ( 1/4" ~ 4" )
- End Connection Threaded Ends
- Working Pressure PN40 for DN8 ~ DN100
- Temperature Range -4 to 320 °F ( -20 to 160 °C ) for PTFE.

**STANDARDS**

- Design EN 12516-1/2/3
- Threaded End NPT/ BS 21 ( BSP ) / BSPT / ISO 228-1 / DIN 2999 / ISO 7-1Rp
- Socket Weld End ASME/ANSI B16.11
- Butt Weld End ASME/ANSI B16.25
- Face to Face MFG Standard
- Material EN1503-1
- Pressure Testing EN 12266

**CERTIFICATE**

- Quality Assurance ISO 9001
- Material Certificate EN 10204-3.1 MTR
- CE Approval PED 97/23/EC Module H

MATERIAL LIST			DIMENSION								
NO.	PART NAME	MATERIAL ( more options available )	SIZE		PORT	L		L1	L2	SW	BW
			TH / SW	BW							
1	BODY	EN1503-1 1.4408	DN8	1/4"	12.0	53	63	14.0	12.0	14.0	18.0
			DN10	3/8"	12.0	53	63	14.0	12.0	17.5	19.5
4	DISC	EN1503-1 1.4408	DN15	1/2"	15.0	64	64	18.0	12.7	22.0	23.2
			DN20	3/4"	20.0	69	79	22.0	14.3	27.5	28.0
5	SPRING	SS316 WPA	DN25	1"	25.0	79	89	27.5	16.0	34.5	34.0
			DN32	1-1/4"	32.0	92	92	32.0	18.0	43.3	41.0
9	END CAP	EN1503-1 1.4408									
11	BODY SEAL	TEFLON									
35	BODY BOLT	SS304									
36	BOLT WASHER	SS304									
37	BOLT NUT	SS304									
43	HOLDER	SS316	SIZE		PORT	L		L1	L2	SW	BW
			TH / SW	BW							
			DN8	1/4"	0.47	2.08	2.48	0.55	0.47	0.55	0.70
			DN10	3/8"	0.47	2.08	2.48	0.55	0.47	0.68	0.76
DN15	1/2"	0.59	2.51	2.51	0.70	0.50	0.86	0.91			
									DN20	3/4"	0.78
DN25	1"	0.98	3.11	3.50	1.08	0.62	1.35	1.33			
									DN32	1-1/4"	1.25

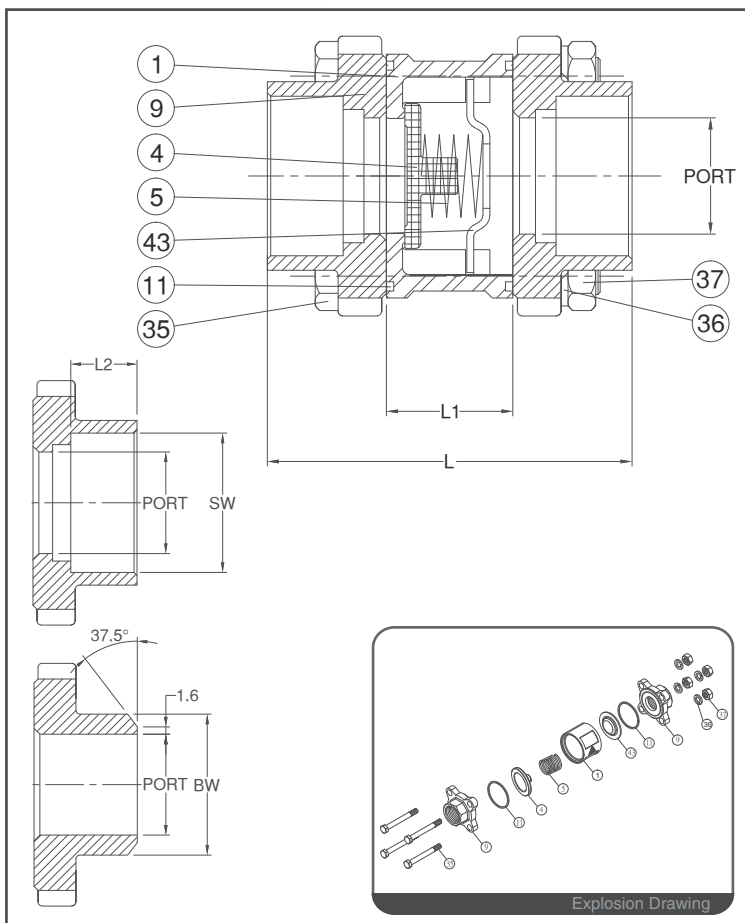

**FEATURES**

- Investment Cast Body Construction
- 3 Pieces Body Design
- Spring Type
- Horizontal or Vertical Installation
- Low Pressure Drop
- For General Chemical and Industrial application

**SPECIFICATIONS**

- Size Range DN8 ~ DN100 ( 1/4" ~ 4" )
- End Connection Threaded Ends
- Working Pressure PN40 for DN8 ~ DN100
- Temperature Range -4 to 320 °F ( -20 to 160 °C ) for PTFE.

**STANDARDS**

- Design EN 12516-1/2/3
- Threaded End NPT/ BS 21 ( BSP ) / BSPT / ISO 228-1 / DIN 2999 / ISO 7-1Rp
- Socket Weld End ASME/ANSI B16.11
- Butt Weld End ASME/ANSI B16.25
- Face to Face MFG Standard
- Material EN1503-1
- Pressure Testing EN 12266

**CERTIFICATE**

- Quality Assurance ISO 9001
- Material Certificate EN 10204-3.1 MTR
- CE Approval PED 97/23/EC Module H

MATERIAL LIST			DIMENSION								
NO.	PART NAME	MATERIAL ( more options available )	SIZE		PORT	L		L1	L2	SW	BW
			DN	IN		TH / SW	BW				
1	BODY	EN1503-1 1.4408	DN40	1-1/2"	40.0	101	106	37	20.0	49.2	49
4	DISC	EN1503-1 1.4408	DN50	2"	50.0	115	125	47	22.5	61.2	62
5	SPRING	SS316 WPA	DN65	2-1/2"	65.0	145	150	47	27.0	77.0	78
9	END CAP	EN1503-1 1.4408	DN80	3"	80.0	154	169	55	29.0	89.9	94
			DN100	4"	100.0	180	210	70	38.0	115.0	125
11	BODY SEAL	TEFLON									
35	BODY BOLT	SS304									
36	BOLT WASHER	SS304									
37	BOLT NUT	SS304									
43	HOLDER	SS316									

			DIMENSION							
	SIZE	PORT	L		L1	L2	SW	BW		
			TH / SW	BW						
DN40	1-1/2"	1.57	3.97	4.17	1.45	0.78	1.93	1.92		
DN50	2"	1.96	4.52	4.92	1.85	0.88	2.40	2.44		
DN65	2-1/2"	2.55	5.70	5.90	1.85	1.06	3.03	3.07		
DN80	3"	3.14	6.06	6.65	2.16	1.14	3.53	3.70		
DN100	4"	3.93	7.08	8.26	2.75	1.49	4.52	4.92		