

# TA-Luft Test Certified Ball Valve

## Typical Application :

Oil & Gas - Petrochemical – Chemical – Paraffin/Kerosene –  
Emergency Cut-Off - General Industrial

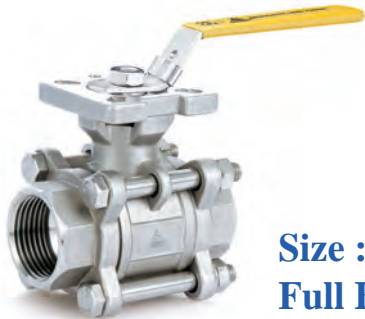

Size : 1/4" ~ 4"  
Full Bore

## V-158

### 3-PIECE TA-Luft Certified INVESTMENT CAST BALL VALVE

- Working pressure (CWP) :  
1000 psi (PN63) / 800 psi (PN40)
- Body material available including Stainless Steel,  
Carbon Steel
- Easy maintenance for chemical and industrial  
application
- Designed and built for economical performance  
with competitively priced
- TA-Luft Fugitive Emission Test Certified
- Blow out proof Stem & anti-static design
- Integral ISO 5211 direct Mounting Flanged  
simplify fit and alignment for actuator
- Floating Ball Design

- A variety of seat materials are available for  
choice including PTFE, RTFE (PTFE with 15%  
G.F.), PTFE with 50% SS316, Carbon filled PTFE,  
Carbon filled PEEK, PEEK, PCTFE, Delrin and  
TFM.
- Lockable handle in open and close position to  
prevent inadvertent operation
- Design as per ASME B16.34
- API 598 , EN12266-1 and MSS SP-55 testing  
and inspection
- NACE MR 0175 upon request
- A wide choice of End Connection are available  
including Threaded End, Socket Weld End, Butt  
Weld End and Flanged End
- In compliance with ATEX 94/9/EC :  
ATEX II 2 GD (zones 1 & 21) and  
ATEX III 3 GD (zones 2 & 22)

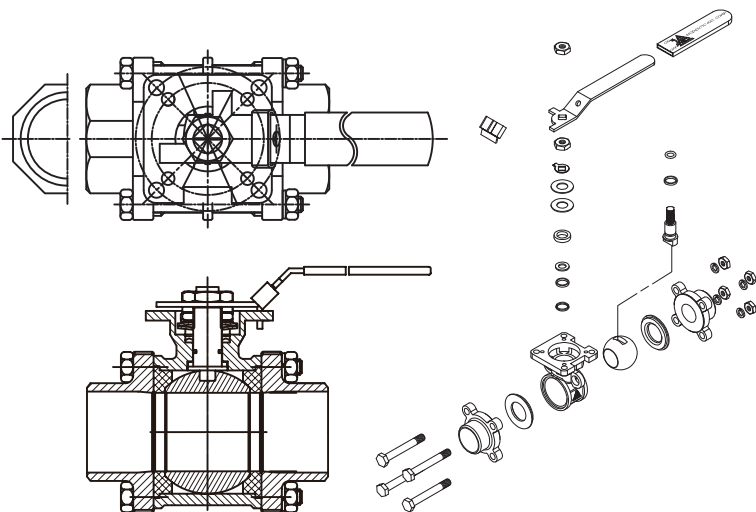

**MODENTIC VALVES**  
MODENTIC INDUSTRIAL CORPORATION



<http://www.ValveBus.com>



www.valvebus.com