



# Two Piece Body Design Flanged Ball Valves, Full Bore

**MONEL® 400 / ANSI CLASS 300**

**Fig No. MD-82 Full Bore**  
1/2" ~ 12" (DN 15 ~ DN 300)



### Features :

- Investment Casting Component for 1/2" ~ 4"
- Blow Out Proof Stem Design, Non Anti-Static Device
- ISO 5211 Mounting Flange
- Standard Stock Without Fire Safe Design
- \* Option : Fire Safe Design

### Standard Compliance :

- Basic Design : ANSI B16.34 Class 300
- Body Material : ASTM
- Face to Face Length : ANSI B16.10 Class 300
- Flange Dimension : ANSI B16.5 Class 300
- Pressure Testing : API 598

### Specification :

- Temperature : -20 to 180 °C (-4 to 356 °F) for RTFE.
- Suggested Application : Hydrofluoric Acid, Caustic Soda, Hydrochloric Acid, Chlorides

### MATERIAL LIST

NO.	PART NAME	MATERIAL
1	BODY	ASTM A494 Gr.M-35-1
4	BALL	ASTM A494 Gr.M-35-1
5	STEM	N04400
9	END CAP	ASTM A494 Gr.M-35-1
11	BODY SEAL	PTFE.
12	SEAT	RTFE.(15%G.F.)
13	THRUST WASHER	PTFE.
14	STEM PACKING	PTFE.
14-1	STEM PACKING	PTFE.
15	GLAND BUSH	SS304
19	HANDLE	SS304
21	HANDLE COVER	PLASTIC
22	HANDLE/STEM NUT	SS304
28	LOCKING DEVICE	SS304
29	BELLEVILLE WASHER	SS301
30	TAB WASHER	SS304
33	STOP PIN	SS304
35	STUD	ASTM A193 Gr.B8
37	BOLT NUT	ASTM A194 Gr.8

FLANGE DIMENSION : ANSI B16.5  
FACE TO FACE : ANSI B16.10

### DIMENSIONS

SIZE	PORT	L	E	H	H1	H2	C	ØY	ØG	ØJ	ØI	T	F	M	ØN	ØK	Z	
DN15	1/2"	15	140	165	66	14	8	6.35	9.3	95.0	66.5	35.0	14.3	1.6	4	16	42	M5x0.8
DN20	3/4"	20	152	165	74	14	8	6.35	9.3	117.0	82.5	43.0	15.9	1.6	4	19	42	M5x0.8
DN25	1"	25	165	200	87	19	11	8.0	10.9	124.0	89.0	51.0	17.5	1.6	4	19	50	M6x1.0
DN32	1-1/4"	32	178	200	92	19	11	8.0	10.9	133.0	98.5	64.0	19.1	1.6	4	19	50	M6x1.0
DN40	1-1/2"	38	190	250	105	23	14	9.5	15.7	156.0	114.5	73.0	20.7	1.6	4	22	70	M8x1.25
DN50	2"	50	216	265	115	23	14	9.5	15.7	165.0	127.0	92.0	22.3	1.6	8	19	70	M8x1.25

SIZE	PORT	L	E	H	H1	H2	C	ØY	ØG	ØJ	ØI	T	F	M	ØN	ØK	Z	
DN15	1/2"	0.59	5.51	6.50	2.60	0.55	0.31	0.25	0.37	3.74	2.62	1.38	0.56	0.06	4	0.63	1.65	M5x0.8
DN20	3/4"	0.79	5.98	6.50	2.91	0.55	0.31	0.25	0.37	4.61	3.25	1.69	0.63	0.06	4	0.75	1.65	M5x0.8
DN25	1"	0.98	6.50	7.87	3.43	0.75	0.43	0.31	0.43	4.88	3.50	2.01	0.69	0.06	4	0.75	1.97	M6x1.0
DN32	1-1/4"	1.26	7.01	7.87	3.62	0.75	0.43	0.31	0.43	5.24	3.88	2.52	0.75	0.06	4	0.75	1.97	M6x1.0
DN40	1-1/2"	1.50	7.48	9.84	4.13	0.91	0.55	0.37	0.62	6.14	4.51	2.87	0.81	0.06	4	0.87	2.76	M8x1.25
DN50	2"	1.97	8.50	10.43	4.53	0.91	0.55	0.37	0.62	6.50	5.00	3.62	0.88	0.06	8	0.75	2.76	M8x1.25

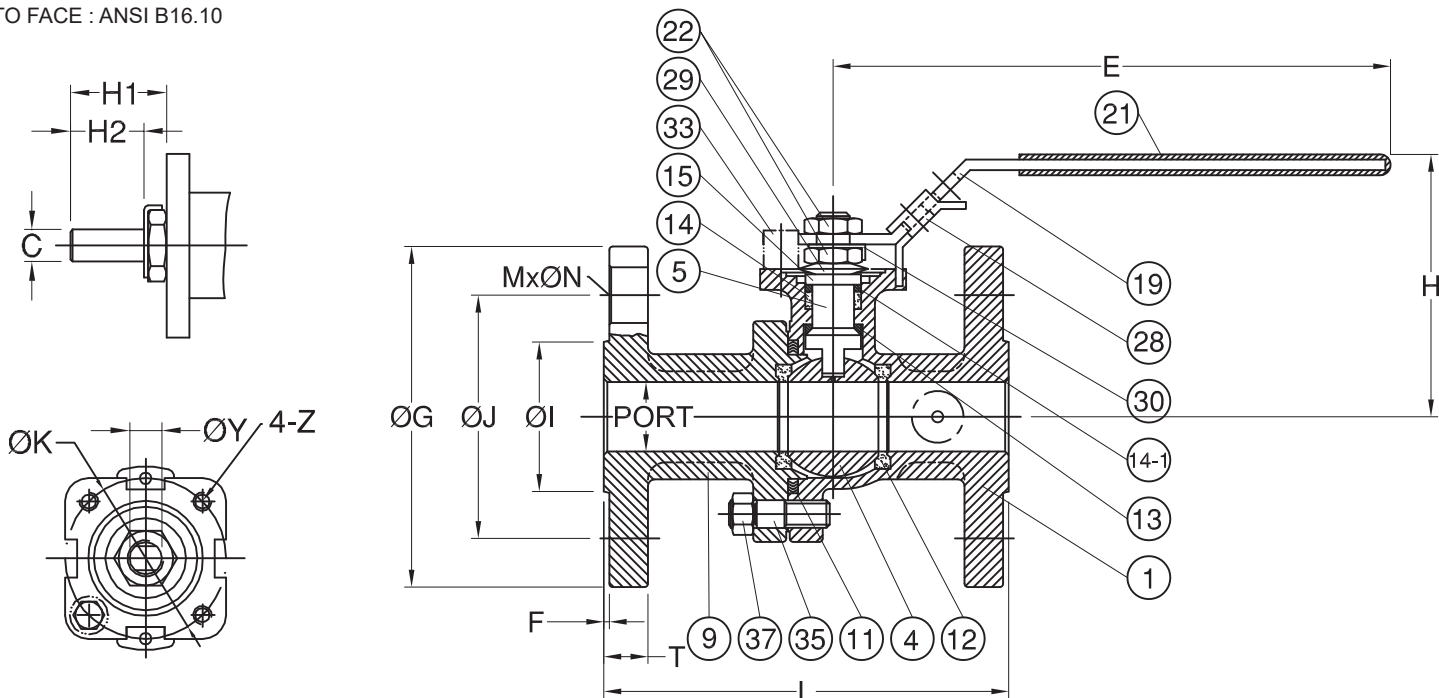



# Two Piece Body Design Flanged Ball Valves, Full Bore

**MONEL<sup>®</sup> 400 / ANSI CLASS 300**

**Fig No. MD-82 Full Bore**  
**1/2" ~ 12" (DN 15 ~ DN 300)**



### Features :

- Investment Casting Component for 1/2" ~ 4"
- Blow Out Proof Stem Design, Non Anti-Static Device
- ISO 5211 Mounting Flange
- Standard Stock Without Fire Safe Design
- \* Option : Fire Safe Design

### Standard Compliance :

- Basic Design : ANSI B16.34 Class 300
- Body Material : ASTM
- Face to Face Length : ANSI B16.10 Class 300
- Flange Dimension : ANSI B16.5 Class 300
- Pressure Testing : API 598

### Specification :

- Temperature : -20 to 180 °C ( -4 to 356 °F ) for RTFE.
- Suggested Application : Hydrofluoric Acid, Caustic Soda, Hydrochloric Acid, Chlorides

### MATERIAL LIST

NO.	PART NAME	MATERIAL
1	BODY	ASTM A494 Gr.M-35-1
4	BALL	ASTM A494 Gr.M-35-1
5	STEM	N04400
9	END CAP	ASTM A494 Gr.M-35-1
11	BODY SEAL	PTFE.
12	SEAT	RTFE.(15%G.F.)
13	THRUST WASHER	PTFE.
13-1	THRUST WASHER	PTFE.
14	STEM PACKING	PTFE.
14-1	STEM PACKING	PTFE.
15	GLAND BUSH	SS304
19	HANDLE	FCD
33	STOPPER	SS304
35	STUD	ASTM A193 Gr.B8
37	BOLT NUT	ASTM A194 Gr.8
41	SNAP RING	NICKEL PLATED CARBON STEEL
42	GLAND BOLT	SS304
47	GLAND FLANGE	ASTM A351 Gr.CF8
56	STEM BEARING	PTFE.

FLANGE DIMENSION : ANSI B16.5  
 FACE TO FACE : ANSI B16.10

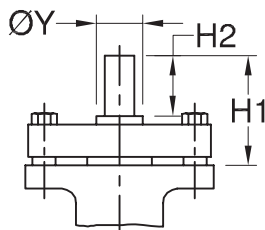
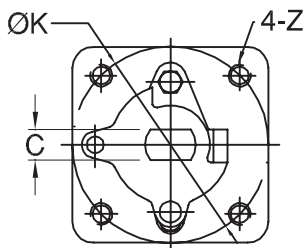

### DIMENSIONS

SIZE	PORT	L	E	H	H1	H2	C	ØY	ØG	ØJ	ØI	T	F	M	ØN	ØK	Z	
DN65	2-1/2"	65	241	390	158	78	44.5	17.0	28.0	190.0	149.0	105.0	25.4	1.6	8	22	102	M10x1.5
DN80	3"	80	283	390	166	78	44.5	17.0	28.0	210.0	168.0	127.0	28.6	1.6	8	22	102	M10x1.5
DN100	4"	100	305	390	183	78	44.5	17.0	28.0	254.0	200.0	157.0	31.8	1.6	8	22	102	M10x1.5

SIZE	PORT	L	E	H	H1	H2	C	ØY	ØG	ØJ	ØI	T	F	M	ØN	ØK	Z	
DN65	2-1/2"	2.56	9.49	15.35	6.22	3.07	1.75	0.67	1.10	7.48	5.87	4.13	1.00	0.06	8	0.87	4.02	M10x1.5
DN80	3"	3.15	11.14	15.35	6.54	3.07	1.75	0.67	1.10	8.27	6.61	5.00	1.13	0.06	8	0.87	4.02	M10x1.5
DN100	4"	3.94	12.01	15.35	7.20	3.07	1.75	0.67	1.10	10.00	7.87	6.18	1.25	0.06	8	0.87	4.02	M10x1.5

