

**Fig No: FPCF-600 Intergral body flanged**  
**1/2"~ 2" DN15 ~ DN50**

**Features :**

Integral flanged valves are available in bonnet designs. The design is the Bolted Bonnet, With male-female joint, spiral wound gasket, made in F304L/graphite. Ring joint gasket are also available on request. Integral flanged end valves are available in gate, globe, piston check design configuration.



**Gate valve Design Construcion and Specifications :**

Weld flanged end valves conform to API602, MSS-SP-118 (as applicable), and ANSI B16.34. BS 5352. Each are tested according to API 598, Marking is per MSS SP-25.

**Construcion is as follows :**

- Full Port or Conventional Port
- Face to Face according to ANSI B16.10
- Flanges according to ANSI B16.5
- Integral body flanges
- Bolted bonnet with spiral-wound gasket

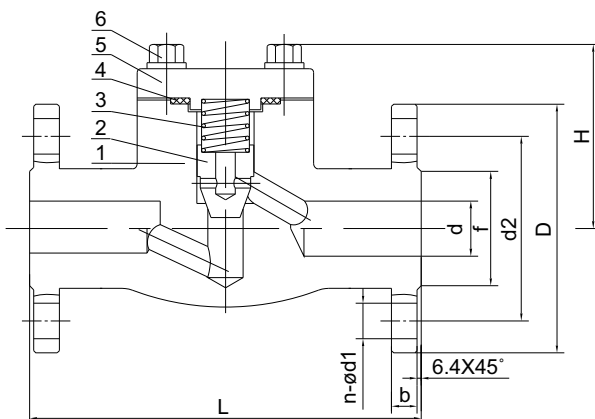

**DIMENSIONS**

unit:mm

NPS	d	f	d2	D	b	n- $\phi d_1$	L	H
1/2	13	35	66.5	95	15	4-16	165	61
3/4	19	43	82.5	117	16	4-16	190	79
1	25	51	89	124	18	4-16	216	95
1-1/4	32	64	98.5	133	21	4-16	229	103
1-1/2	38	73	114.5	156	23	4-22	241	118
2	51	92	127	165	26	8-19	292	135

**MATERIALS LIST**

NO	Name	MATERIAL		
1	BODY	A105	F304(L)	F316(L)
2	PISTON DISC	A182 F6	F304(L)	F316(L)
3	SPRING	F304	F316	
4	GASKET	F304+GRAPHITE		F316+GRAPHITE
5	BONNET	A105	F304(L)	F316(L)
6	BOLT	A193 B7		A193 B8

Other Materials Also Available On Requested