



Fig No: MD-54-900 Full Bore
16"~36"



Feature:

- Design: API6D, ASME B16.34, API607/ API6FA fire safe design
- Side entry ball
- Anti-static design, Anti blow-out-stem
- Carbon steel or special alloy upon request
- Cast steel are also supplied in full compliance with NACE MR0175

Service:

- General, Low Temperature, Cryogenic, Sub sea, Oil & Gas application, High temperature, Underground

Design:

- 3-pc Design, by casting
- Full Bore
- Face to face: ASME B16.10
- Flange connection: ASME B16.5 Class 900 RF (Above size 26", which would compliance with ASME B16.47)
- Pressure-Temperature Rating: ASME/ANSI B16.34
- Testing and inspection: API6D, API598
- Automatically Drain Plug (NPT) on Body(2"~4" - option, Upward 6" - Basic function)
- Double bleed and Block(2"~4" - option, Upward 6" - Basic function)
- Sealant Emergently Injection Fittings(2"~4" - option, Upward 6" - Basic function)

Options:

- With Locking Device
- Extended Stem (Cryogenic application)
- Actuator installation
- Gear Box

Size:16"~18"

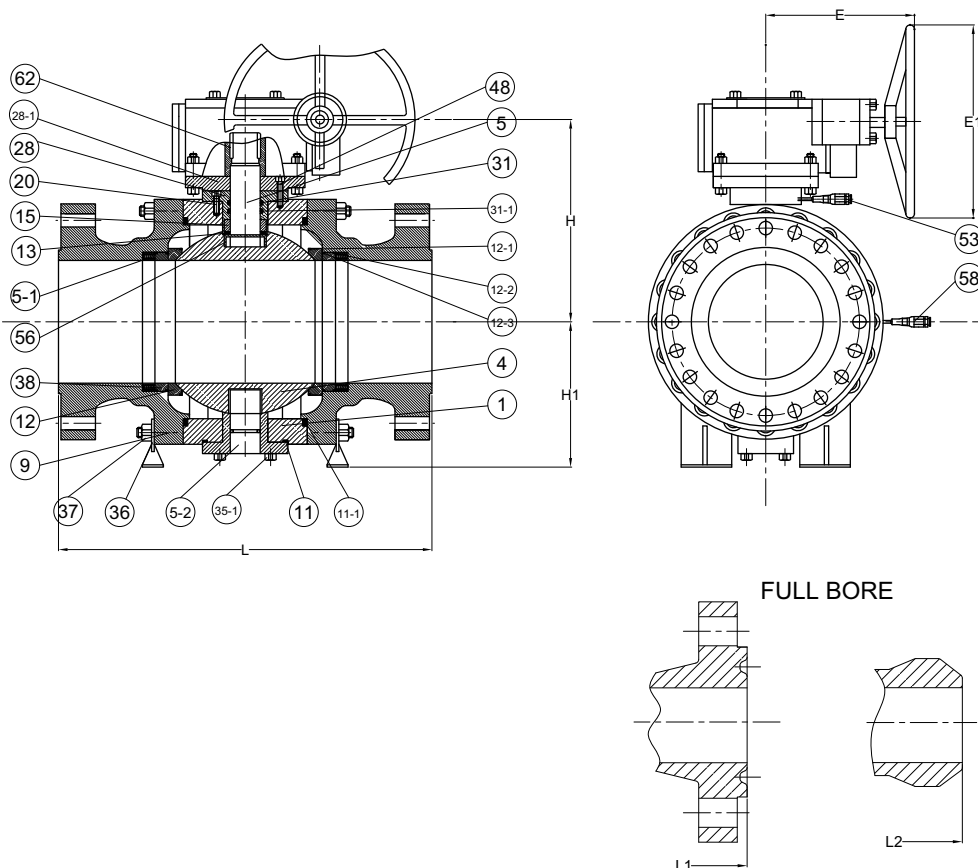
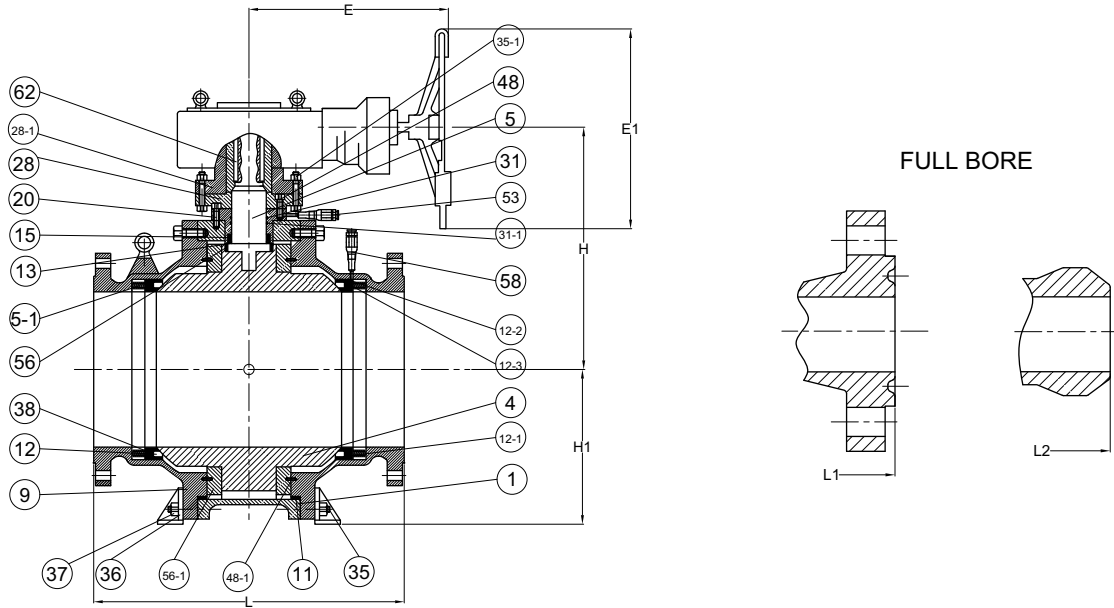



Fig No: MD-54-900 Full Bore

Size:20"~36"



MATERIALS LIST

| NO. | PART NAME | MATERIAL |
|------|------------------|--|
| 1 | BODY | A216-WCB,WCC,A352-LCB,A351-CF8,CF8M,CF3,CF3M,CN7M,CF8C,CDMCu,CN-3MN |
| 4 | BALL | A105+ENP,A182-F6,F304,F316,F304L,F316L,F321,F51,F53,ALLOY-20 |
| 5 | STEM | 1045+ENP,A182-F6,F304,F316,F304L,F316L,F321,F51,F53,ALLOY-20,4140+ENP,17-4PH |
| 5-1 | SPRING | SS304,INCONEL,1566+ENP |
| 9 | CAP | A216-WCB,WCC,A352-LCB,A351-CF8,CF8M,CF3,CF3M,CN7M,CF8C,CD4MCu,CN-3MN |
| 11 | GASKET | SS304,SS316+FLEXIBLE GRAPHITE SPIRAL WOUND |
| 12 | SEAT | PTFE,RPTFE,NYLON,PEEK,PPL,POM, KARBATE,MOLON,DEVLON |
| 12-1 | SEALING RING | FLEXIBLE GRAPHITE |
| 12-2 | SEALING RING | SS304,SS316+FLEXIBLE GRAPHITE SPIRAL WOUND |
| 12-3 | O-RING | VITON |
| 13 | THRUST WASHER | PTFE,RPTFE,STAINLESS STEEL+N |
| 15 | PACKING | FLEXIBLE GRAPHITE |
| 20 | SCREW | 1035,STAINLESS STEEL |
| 28 | STUFFING BOX | A105+ENP,A182-F6,F304,F316,F304L,F316L,F321,F51,F53,ALLOY-20 |
| 28-1 | CONNECTING PLATE | 1025,A216-WCB,A351-CF8 |
| 31 | O-RING | VITON |
| 31-1 | O-RING | NBR,VITON |
| 35 | BOLT | A193-B7,B7M,B8,B8M |
| 35-1 | SCREW | 1025,SS304 |
| 36 | ADJUST WASHER | PTFE,1045+RPTFE,STAINLESS STEEL+RPTFE |
| 37 | NUT | A194-2H,2HM,8,8M |
| 38 | SEAT RING | A105+ENP,A182-F6,F304,F316,F304L,F316L,F321,F51,F53,ALLOY-20 |
| 48 | PIN | ANSI 1566 |
| 48-1 | PIN | 1045,SS |
| 53 | OIL CUP | 1025,SS304 |
| 56 | BEARING | 1045+RPTFE,SS304+RPTFE,SS316+RPTFE |
| 56-1 | BEARING RETAINER | 1025,A216-WCB,A351-CF8 |
| 58 | GREASE FITTING | 1025,SS304,SS316,SS304L,SS316L,SS321,ALLOY-20,F51,F53 |
| 62 | KEY | 1045 |



Fig No: MD-54-900 Full Bore

ANSI CLASS 900 DIMENSIONS

unit:mm

| SIZE | L | L1 | L2 | E | E1 | H | H1 | Wt1(kg) | Wt2(kg) |
|---------|---------|---------|---------|-------|-------|--------|-------|---------|---------|
| 16" | 1130.0 | 1140.0 | 1130.0 | 530.0 | 550.0 | 727.0 | 406.0 | 1998.0 | 1903.0 |
| 18" | 1219.0 | 1232.0 | 1219.0 | 530.0 | 550.0 | 785.0 | 418.0 | 2145.0 | 2300.0 |
| 20" | 1321.0 | 1334.0 | 1321.0 | 530.0 | 550.0 | 839.0 | 561.0 | 3135.0 | 2985.0 |
| 24" | 1549.0 | 1568.0 | 1549.0 | 530.0 | 550.0 | 853.0 | 634.0 | 5295.0 | 5040.0 |
| 26" | *1651.0 | *1674.0 | *1651.0 | --- | 812.0 | 909.0 | 725.0 | 6365.0 | 6060.0 |
| 28" | *1753.0 | *1775.0 | *1753.0 | --- | 914.0 | 980.0 | 765.0 | 7635.0 | 7270.0 |
| 30" (R) | *1880.0 | *1902.0 | *1880.0 | --- | 914.0 | 1095.0 | 810.0 | 8846.0 | 8425.0 |
| 32" (C) | *2032.0 | *2054.0 | *2032.0 | --- | 914.0 | 1270.0 | 840.0 | 10068.0 | 9589.0 |
| 34" (C) | *2159.0 | *2188.0 | *2159.0 | --- | 914.0 | 1310.0 | 860.0 | 14250.0 | 13545.0 |
| 36" | *2286.0 | *2315.0 | *2286.0 | | 914.0 | 1445.0 | 893.0 | 15372.0 | 14645.0 |

* (R) Reduce Bore (C) Regular Bore

* Modentic Reserves The Rights To Change Any Details Without Prior Notice.